

## FLOATING ABOVE THE AEGEAN SEA AT CRETE

It is impossible to imagine the world without luxurious wellness centres and equally luxurious yacht clubs.

Architects jostle to surpass one another in shaping forms and structures into contemplation spaces.

Luxury and comfort as an escape from a stressful society and far away from the seething mass of charter tourists crowding airports and beaches.

The Swiss designer, Davide Macullo, was invited to come up with a plan at Grand Resort Elounda Beach on Crete for a far-reaching refurbishment of the spa and wellness centre and the villas at the yachting club complex.

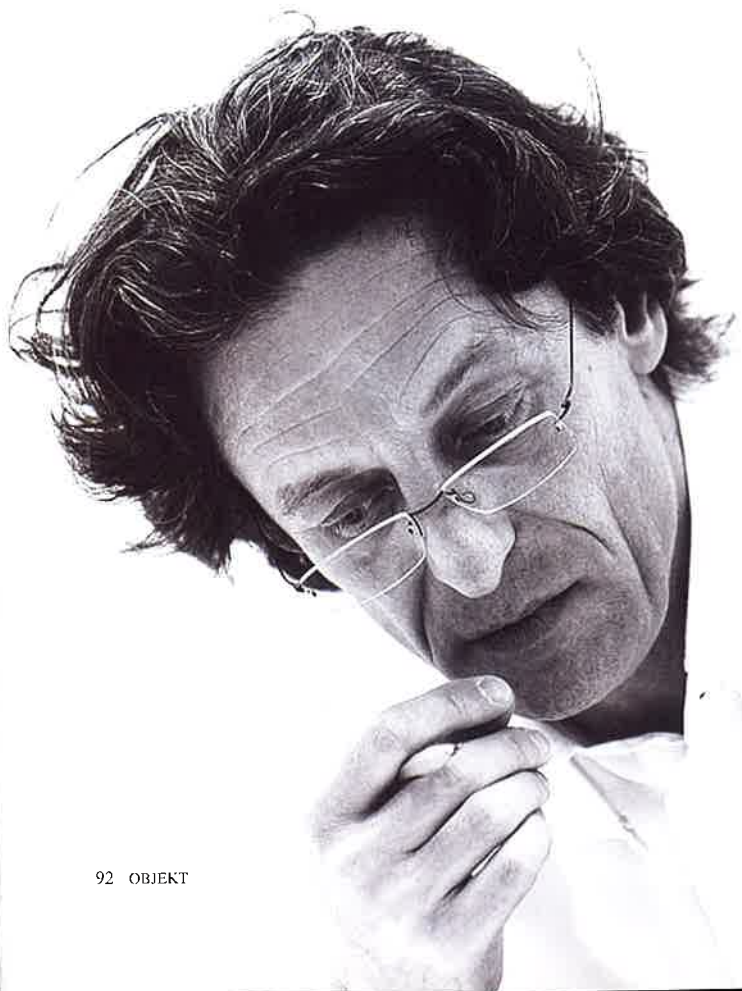

text: Mercedes Zampoli  
photos: Enrico Cano

**Above: rounded surfaces of the yachting club villas at Grand Resort, Elounda Beach on the Greek island of Crete. Here, the Swiss architect Davide Macullo refurbished the yacht club and the imposing wellness centre, transforming them into a open, opulent complex.**

**Adjoining, right: the yachting club villas beside the Aegean Sea on the island's north-east coast. They are evocative of a flotilla of super-yachts at anchor.**

**Left: the architect Davide Macullo.**







These pages feature the interiors of the yachting club villas at Grand Resort, Elounda Beach on Crete in fresh, modern colours and with large expanses of glass to accentuate the openness of the architecture. Architect Davide Macullo used dark stone on the exterior of the villas, while employing woods in a variety of colours, ranging from whitened oak to teak, as well as leather and – in particular – plenty of glass and transparent materials. The colours indoors are primarily light and restful. Almost all the villas' rooms have uninterrupted sea views. The large open-plan sitting room can be partitioned off into more intimate spaces. Bottom of page: the lay-out of the yachting club villas.

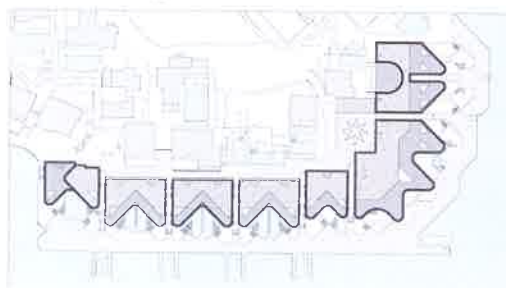





The project is located at the north-east coast of the Greek island of Crete. It consists of villas and a hotel, with the yacht club and large wellness centre as pivotal features. The interiors and overall look of the imposing complex were recently given a thorough make-over by the architect Davide Macullo, who has adapted it to present-day standards.

The yacht club has two rows of villas at varying levels, all with sea views. They have been designed as a transition between sea and land, with newly constructed pathways providing unexpected vistas.

The architect has used stone in dark colours for the outside walls, making for harmony with the natural surroundings. The use of materials like wood and leather define the atmosphere of the interior.

The main object of the interior design was to create a sumptuous open-plan totality with sea views from almost every room. If greater intimacy is required, the large spaces can be divided into small units using architectural devices and items of furniture. In the living area the architect opted for natural materials in pale shades, for both the furniture and the finishes. That space can be closed off from the bedroom section with a sound-proof sliding panel. In the bedrooms the beds are positioned to afford views of the pool. The bathrooms in all the villas vary, though, for harmony, all contain marble and wood: marble in differing dark shades and wood finishes in colours ranging from teak to whitened oak. The baths are sunk into the floor and when the doors are open afford views of the

water beyond. Lighting can be adapted to the occupant's personal requirements: from the central panel a variety of moods can be conjured up.

The wellness centre at Elounda Beach resort is housed in the hotel's former penthouse. A complete make-over was needed, with visual continuity between the internal space and the surrounding landscape a priority.

The elevated setting gives visitors the feeling of 'floating' high above the Aegean. The design is based on a series of white Greek 'boxes', which host a variety of functions. The choice of materials, colours and textures evokes a feeling of relaxation and makes for visual neutrality. The complex offers two types of wellness treatment: one in relation to water, the other to the functioning of the body. And all with uninterrupted sea views.











These pages: the wellness centre now accommodated in the penthouse on the roof of Elounda Beach resort was designed by Davide Macullo. His design resembles a series of white Greek 'boxes' orientated towards the sea. Visitors will feel as if they are floating high above the Aegean. For the interior the architect opted for restful, pastel shades and an abundance of natural materials. Glass and transparent panels in walls and ceilings make for a relaxed ambience and visual neutrality.